

## Allproof Low Profile Fire Collar Plastic Pipe through a Concrete/Speedpanel Wall See pg 2 for details

### INSTALLATION INSTRUCTIONS:

1. Ensure substrate around the service is flat and free from obstructions.
2. Seal the annular space between the wall and the pipe with Allproof MAS310 fire sealant to a depth of 13mm and for Speedpanel also seal any profile gaps.
3. Open pipe collar and position around the service.
4. Slide tab through slot in pipe collar and fold back 180° to secure.
5. Secure collar using 10G x 38mm needle point screws with 15mm diam washers.

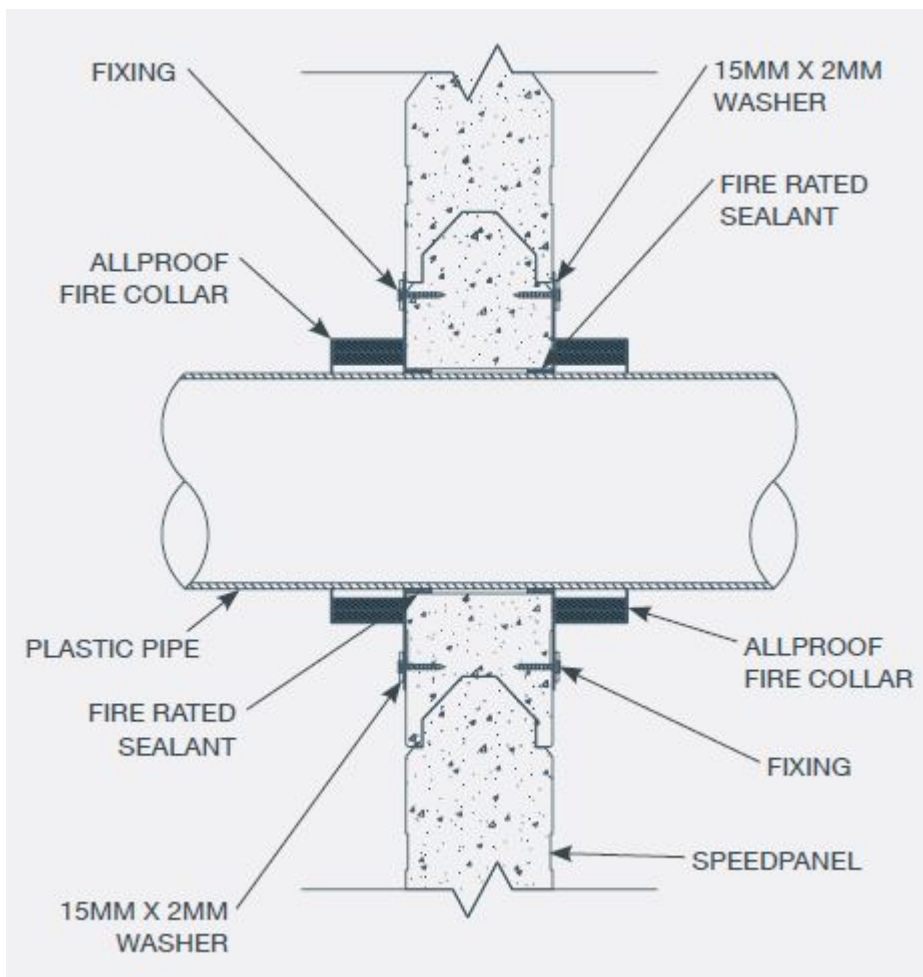

BRANZ Appraised  
Appraisal No.1088 [2019]

As a part of our policy of on-going product development and testing, we reserve the right to modify, alter or change product specifications without giving notice. All information contained in this document is given in good faith and is provided for guidance only. Any drawings provided are for illustrative purposes only. As Firestop Centre has no control over the methods or competence of installation and of prevailing site conditions, no warranties, expressed or implied, is intended to be given as to the actual performance of the product mentioned or referred to herein and no liability whatsoever will be accepted for any loss, damage or injury arising from the use of the information given.

# ALLPROOF

INDUSTRIES

Allproof Industries Ltd  
17 Bay Park Place  
Beach Haven, AK 0626



BRANZ Appraisal 1008  
Technical Manual - Plumbing Pg 17  
AS1530.4-2014 AS4072.1-2005

System/FPA Register ID# FC750

<b>Products</b>	Allproof Low-Profile Fire Collar
<b>Application</b>	Fire stopping of plastic pipe in concrete or speedpanel wall
<b>Construction</b>	Minimum wall thickness 78mm

### Fire Classification:

See page 2 for details of pipe types, sizes and FRR ratings for:

PVC up to 150mm  
HDPE up to 100mm

See also plasterboard wall systems FC632, FC633, FC737, FC738, FC742 which are all approved for concrete walls as well, covering:-

PVC up to 150mm diam  
PVC with socket up to 100mm diam  
HDPE up to 110mm diam Ploybute up to 28mm diam  
PEXa up to 25mm diam  
Ruapiano PP-MD up to 100mm diam  
D Blue PP-MD up to 110mm diam  
PP-R up to 110mm diam  
PEX/AL/PEX up to 20mm diam PEX/AL/PE up to 20mm diam  
PE-RT/AL/PE-RT up to 40mm diam  
PB up to 20mm diam

Sheet size: <b>A4</b>	Drawn date & no: 28/7/23
Scale: <b>NTS</b>	Drawn by: G.P

# SPEEDPANEL TEST RESULTS:

NOMINAL PIPE SIZE (MM)	PANEL DEPTH (MM)	NOMINAL PIPE WALL THICKNESS (MM)	PRODUCT CODE	PENETRATION HOLE SIZE (MM)	WALL FRL	FTC#
<b>PVC PLASTIC PIPE</b>						
50	78	2.3	ALLFC50	63	-/120/120	190283.1
100	78	3.0	ALLFC100	114	-/120/120	190283.1
150	78	4.2	ALLFC150	165	-/120/90	190283.1
<b>HDPE PLASTIC PIPE</b>						
50	78	3.0	ALLFC50	60	-/120/90	190283.1
100	78	4.3	ALLFC100	114	-/120/90	190283.1

Fixing: Collars tested using 10G x 38mm needle point screws with Ø15mm x 2mm thick washers.

Note: Intumescent sealant installed between Speedpanel and collar where profile changes (see 'Profile Detail').

## SPEEDPANEL INSTALLATION DETAILS:

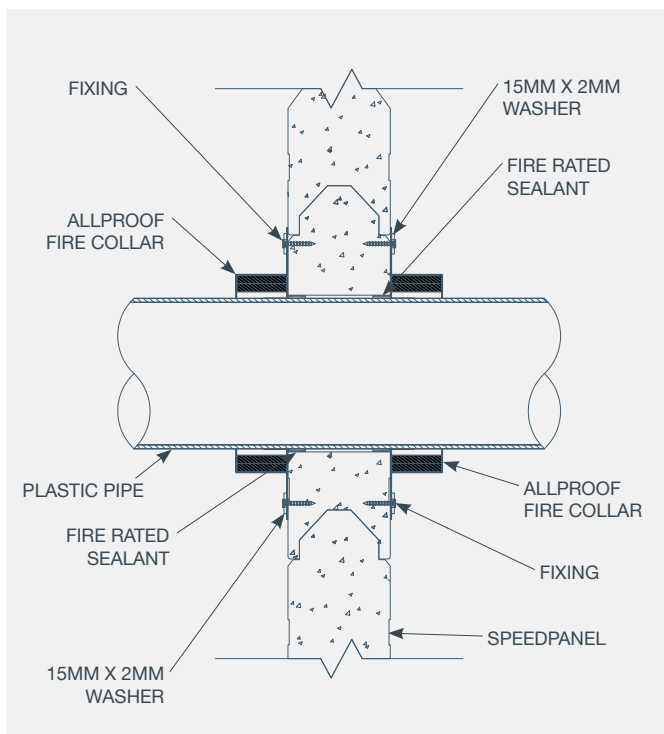

## SPEEDPANEL PROFILE DETAIL:

